



**Doors 4.0**





## INDICE

L'OMBRA	6
LIEVITO	10
EFFECT	14
LAYER	22
DRAPPO	28
NEW CLASSIC SCULTURE	30
TARSIA	34
TRISTAN	36
ALL	42
MODELLI COLLEZIONI	44
FINITURE LEGNO	46
VETRI ED INSERTI	47
METALSHADES 4.0	48
LACCATI 4.0	49
MANIGLIE	50
FINITURE FERRAMENTA	51
TELAI	52



## NOVITÀ NEWS

Nuove finiture, rivisitazioni e materiali inediti sono i protagonisti del catalogo Romagnoli 2020 che racconta il progetto attraverso un nuovo linguaggio, pur mantenendo lo stile inconfondibile dell'azienda.

Le collezioni 2020 sono frutto della ricerca continua che si svolge all'interno di Romagnoli design LAB, il laboratorio creativo dove le idee prendono forma e dove nasce l'innovazione tecnologica e la ricerca stilista.

*New finishes, reinterpretations and new materials are the protagonists of the Romagnoli 2020 catalogue which tells the project through a new language, while maintaining the unmistakable style of the company. The 2020 collections are the result of continuous research that takes place in Romagnoli design LAB, the creative laboratory where ideas take shape and where technological innovation and designer's research are born.*



### **Innovazione, design e qualità: Romagnoli design LAB**

Il Centro di ricerca & sviluppo rappresenta l'identità di Romagnoli. Un laboratorio creativo sempre in evoluzione e luogo di scambio fra le diverse esperienze.

Ricerca e tecnologia rappresentano i due elementi strategici.

La tecnologia si sviluppa attraverso la continua sperimentazione di nuovi materiali e tecnologie che, data in mano ai designer possono esprimere la loro visione creativa in linea con il dna dell'azienda.

### ***Innovation, design and quality: Romagnoli design LAB***

*The Research & Development Center represents the identity of Romagnoli. A constantly evolving creative laboratory and a place of exchange between different experiences.*

*Research and technology are the two strategic elements.*

*Technology develops through the continuous experimentation of new materials and technologies that, given in the hands of designers, can express their creative vision in line with the DNA of the company.*



### Un servizio esclusivo: Romagnoli e il mondo del contract

Fa parte di Romagnoli design LAB anche la divisione progettazione e contract, un servizio esclusivo dedicato ai professionisti del mondo contract che, grazie all'esperienza dell'azienda possono richiedere soluzioni personalizzate per progetti estremamente eterogenei fra loro: da forniture medio-piccole, come residenze a grandi complessi, come alberghi. Romagnoli contract è inoltre in grado di proporre e realizzare anche tipologie di prodotto diverse dalla porta tradizionale e porta REI, come boiserie, parquet, cabine armadio, mobili contenitori e complementi di arredo. La divisione è prima di tutto un fornitore di servizi: dal progetto ad ogni fase della realizzazione, il concetto di problem solving è sempre prioritario nei rapporti con la committenza.

### *An exclusive service: Romagnoli and the world of contract*

*The design and contract division is also part of Romagnoli design LAB, an exclusive service dedicated to professionals in the contract world who, thanks to the company's experience, can request customized solutions for extremely heterogeneous projects: from medium to small supplies, such as residences to large complexes, such as hotels. Romagnoli contract is also able to propose and realize different types of products other than doors, such as walk-in wardrobes, storage units and furnishing accessories.*

*The division is first and foremost a supplier of services: from the project to every phase of the realization, the concept of problem solving is always a priority in relations with the client.*





L'OMBRA  
LOM4 H2400 - W08 Mattone, telaio rasomuro

L'OMBRA  
LOM4 H2400 - W08 Mattone, flush-wall-frame

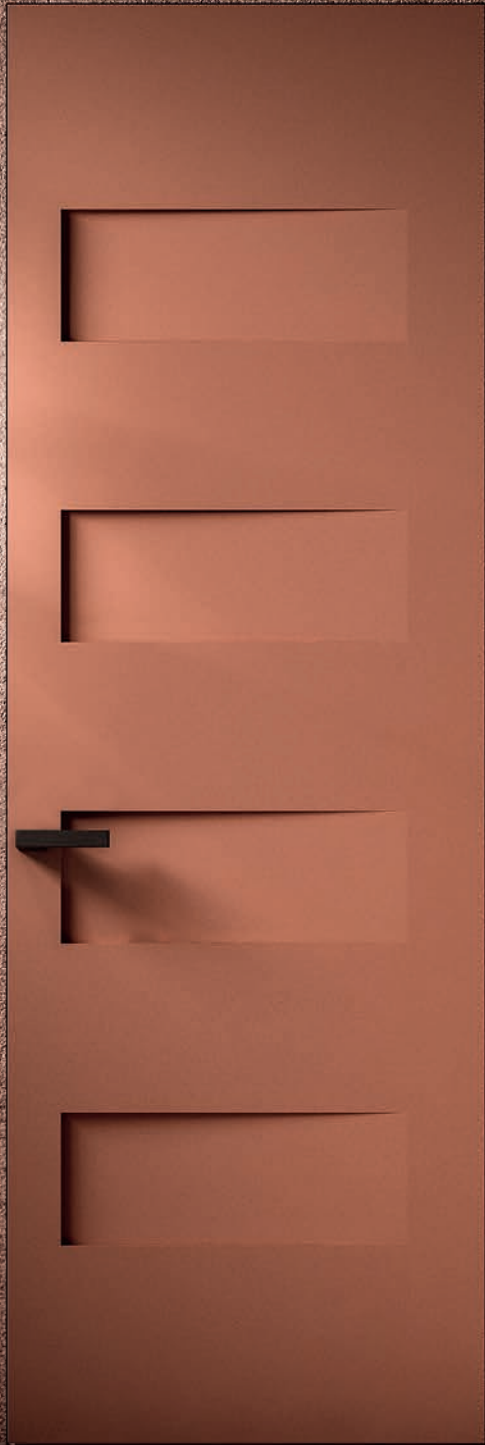

LOM1 - W06 Salmone, telaio complanare  
LOM1 - W06 Salmone, coplanar frame

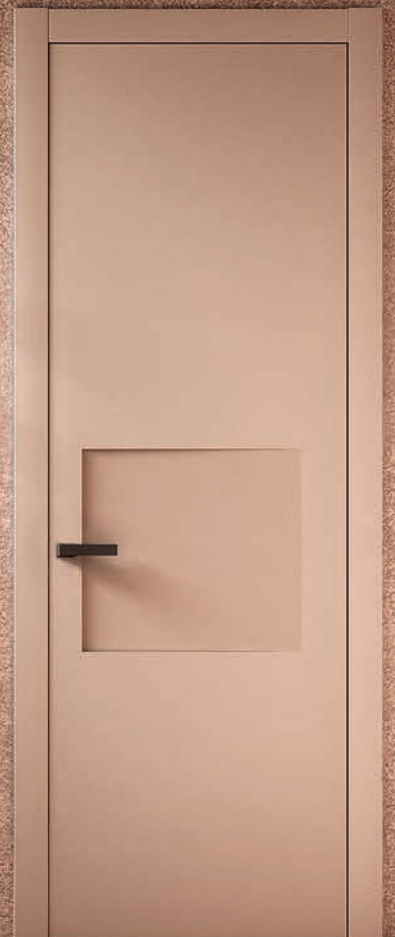



LOMA - W07 Terra, telaio complanare  
LOMA - W07 Terra, coplanar frame





## L'OMBRA



DETTAGLIO  
LOMC2L  
W01 Bianco RAL 9003

*DETAIL*  
*LOMC2L*  
*W01 White RAL 9003*

*“Luce e ombra, linee e angoli, e tutto il mistero del volume inizia a parlare”. La collezione L’ombra diventa protagonista di un gioco di luce ed ombra in uno spazio quasi onirico.*

*“Light and shadow, lines and angles, and the whole mystery of the volume begins to speak”. The L’ombra collection becomes the protagonist of a play of light and shadow.*

L'OMBRA  
LOM2 - W12 Grigio Moderno, telaio complanare

L'OMBRA  
LOM2 - W12 Grigio Moderno, coplanar frame





LIEVITO  
LT3B - W14 Menta Chiara con boiserie

*LIEV*  
*LT3B - W14 Menta Chiara with boiserie*







## LIEVITO



DETTAGLIO  
LTD  
X02 Calcepora Scuro

*DETAIL  
LTD  
X02 Dark Calcepora*



DETTAGLIO  
LT2B  
W09 Tortora Beige

*DETAIL  
LT2B  
W09 Tortora Beige*

Superfici tridimensionali e geometrie semplici raccontano il concept della collezione Lievito. Il design tridimensionale aggiunge profondità alle superfici piane, portando dei pattern decorativi unici nell'ambiente.

*The concept of the Lievito collection is described by three-dimensional surfaces and simple geometries which adds depth to flat surfaces, bringing unique decorative patterns to the environment.*



LIEVITO  
LTD - X02 Calcepora Scuro, telaio complanare

*LIEVITO  
LTD - X02 Dark Calcepora, coplanar frame*





EFFECT  
EFT1P - X01 Calcepora Chiaro, telaio complanare versione Cut, altezza 2700 mm

*EFFECT  
EFT1P - X01 Light Calcepora, coplanar Cut frame, height 2700 mm*







EFFECT  
X01 Calcepura Chiaro

EFFECT  
X01 Light Calcepura



EFFECT  
X03 Spatolato Grigio

EFFECT  
X03 Grey Plaster

La collezione Effect è il risultato della ricerca tecnologica di Romagnoli design LAB, da cui nascono le nuove finiture in grado di reinventare la superficie in legno e conferire alle porte effetti materici unici.

*The Effect collection is the result of the technological research of Romagnoli design LAB, from which the new finishes are born capable of reinventing the wooden surface and to give the doors unique material effects.*



EFFECT  
Y06 Oro Rosa  
Graffiato

*EFFECT*  
*Y06 Scratched*  
*Platinum Rosé*

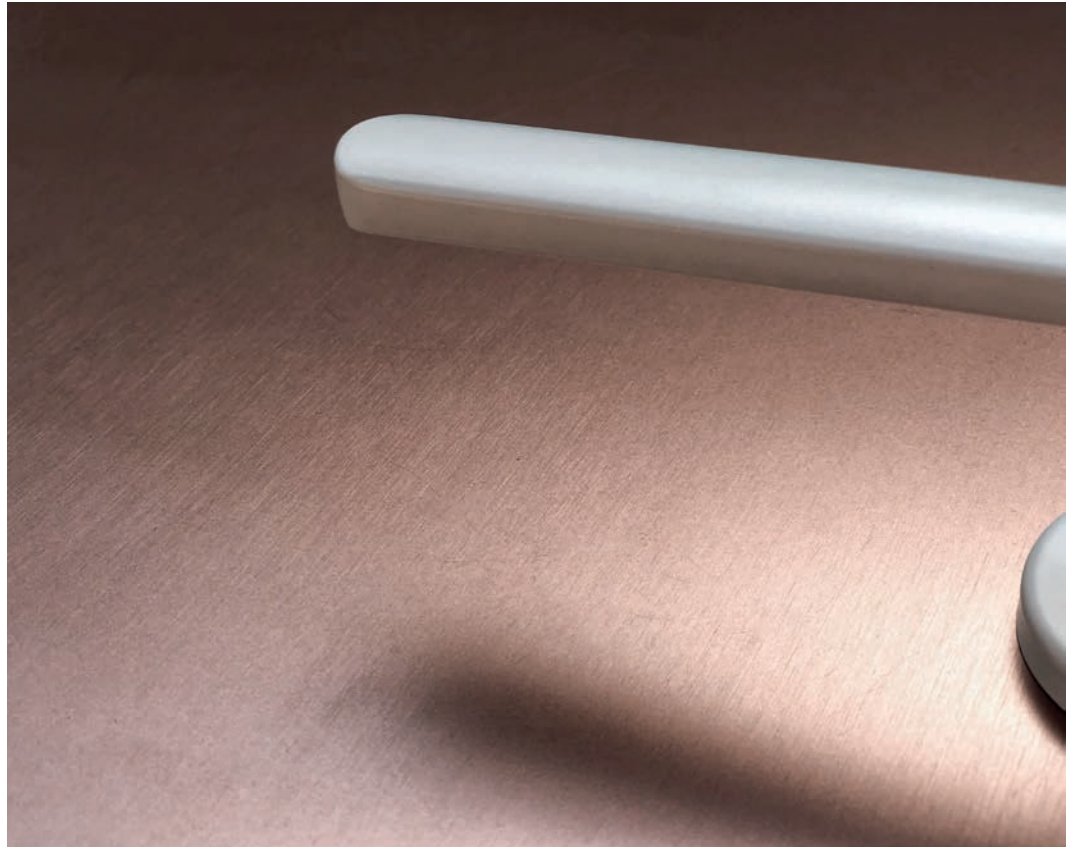

EFFECT  
Y05 Ottone Graffiato

*EFFECT*  
*Y05 Scratched Brass*



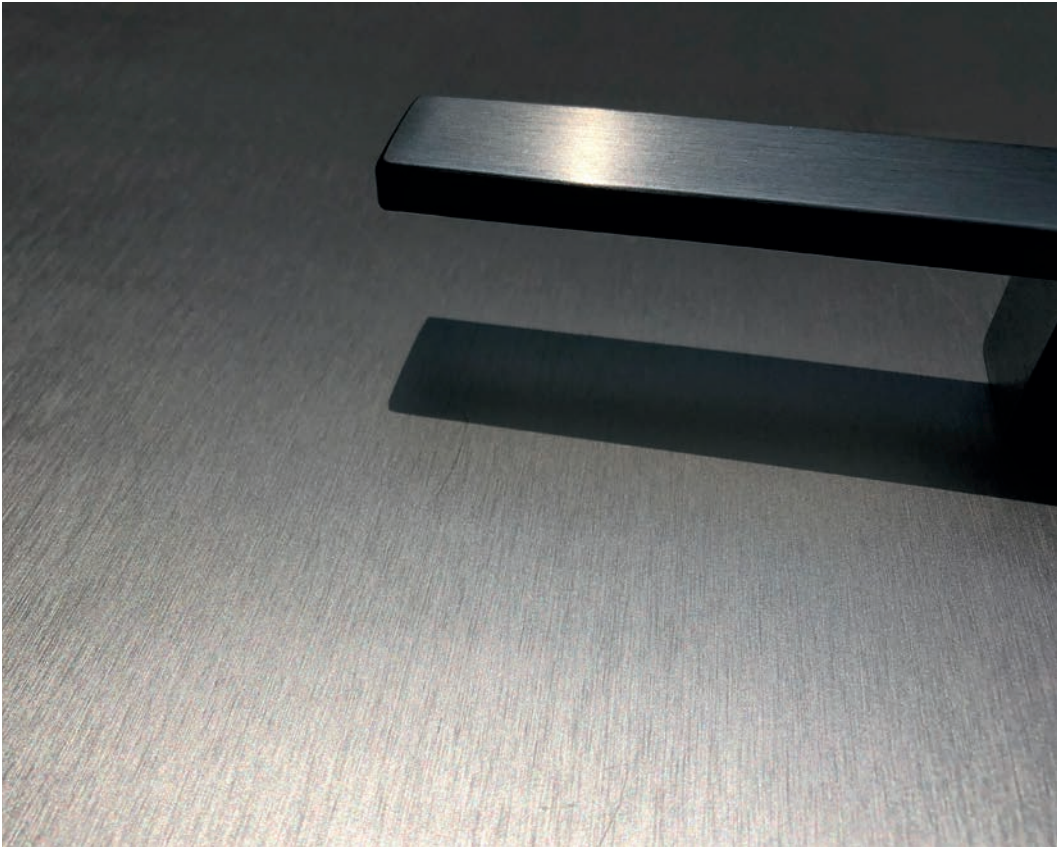

EFFECT  
Y02 Acciaio Graffiato

*EFFECT*  
*Y02 Scratched Steel*



EFFECT  
Y01 Acciaio Anticato

*EFFECT*  
*Y01 Antique Steel*



## EFFECT



DETTAGLIO  
Y03 Ferro Peltro  
con telaio Patch

*DETAIL*  
*Y03 Iron Pewter*  
*with Patch frame*





EFFECT  
EFT1P - Y03 Ferro Peltro, telaio versione Patch finitura a mano

EFFECT  
EFT1P - Y03 Iron Pewter, Patch frame Hand made finish



EFFECT  
EFT1P - W10 Foglia da Té, telaio rasomuro, altezza 2700 mm

*EFFECT  
EFT1P - W10 Foglia da Té, flush-wall -frame, height 2700 mm*





## EFFECT



DETTAGLIO  
EFT1P  
Y04 Ottone Anticato

*DETAIL*  
*EFT1P*  
*Y04 Antique Brass*

## LAYER



DETTAGLIO  
LAYINSV  
W01 Bianco  
RAL 9003 con Inserto  
Oro Rosa Spazzolato

*DETAIL  
LAYINSV  
W01 White RAL 9003  
with Brushed  
Pink Gold Insert*

Romagnoli pone la stessa attenzione che rivolge al legno anche verso gli altri materiali. Nascono così inserti metallici la cui superficie è lavorata a mano per esaltarne la preziosa natura.

*Romagnoli pays the same attention to wood as well as to other materials. In order to enhance their precious nature, the metal inserts are created whose surfaces are hand-made.*

LAYER

LAYINSV - W01 Bianco RAL 9003 con inserto ottone spazzolato, telaio complanare, coprifili con inserto, altezza 2400 mm

LAYER

LAYINSV - W01 White RAL 9003 with brushed brass insert, coplanar frame, casings with insert, height 2400 mm





LAYER  
LAYINSO - W01 Bianco RAL 9003 con inserto cromo spazzolato e  
boiserie con inserto, altezza 2400 mm

LAYER  
*LAYINSO - W01 White RAL 9003 with brushed chrome insert and  
panelling with insert, height 2400 mm*



## LAYER



DETTAGLIO  
LAYINSO  
W01 Bianco RAL 9003  
con Inserto Ottone  
Spazzolato

*DETAIL  
LAYINSO  
W01 White RAL 9003  
with Brushed Brass  
Insert*

## LAYER



DETTAGLIO  
LAY3INS  
W14 Menta Chiara  
con Insetto Ottone  
Spazzolato

*DETAIL  
LAY3INS  
W14 Menta Chiara  
with Brushed  
Brass Insert*

Metalli spazzolati a mano e “intarsiati” con rigosità geometrica e armonia di linee semplici, per ottenere un prodotto in cui prevale l’unicità. Insetti disponibili nelle finiture ottone, oro rosa e cromo.

*Hand-brushed and “inlaid” metals with geometric attention and harmony of simple lines, to obtain a product in which uniqueness prevails. Inserts available in brass, pink gold and chrome finishes.*



LAYER  
LAY3INS - W14 Menta Chiara Sistema Twist  
con Inserto ottone spazzolato, altezza 2700 mm

LAYER  
LAY3INS - W14 Menta Chiara Twist System  
with Brushed brass insert, height 2700 mm





## DRAPPO



DETTAGLIO  
W05 Cipria

*DETAIL*  
*W05 Cipria*

Bassorilievi in vetro applicati all'anta. Lucido ed opaco in contrapposizione. La porta acquisisce un aspetto elegante e raffinato, per esaltare in modo semplice l'ambiente.

*Glass bas-reliefs applied to the door. Shiny and opaque in contrast. The door obtains an elegant and refined appearance to enhance the environment in a simple way.*



DRAPPO  
DRG - W05 Cipria, apertura Magic

DRAPPO  
DRG - W05 Cipria, Magic opening



## NEW CLASSIC SCULTURE



DETTAGLIO  
NW1BLSCL  
W02 Grigio RAL 9002

*DETAIL*  
*NW1BLSCL*  
*W02 Grey RAL 9002*

La collezione New Classic Sculpture è l'esempio di quanto la porta classica in legno massello dimostra di essere sempre al passo con i tempi, anzi diventa una tendenza di arredo. Un tocco classico in un ambiente contemporaneo è l'accostamento vincente per ambienti equilibrati e raffinati.

*The New Classic Sculpture collection is an example of how the classic solid wood door proves to be always a footprint in time, rather it becomes a furniture trend. A classic touch in a contemporary setting is the prominent combination for balanced and refined environments.*



NEW CLASSIC SCULTURE  
NW1BLSCCL - W02 Grigio RAL 9002

NEW CLASSIC SCULTURE  
NW1BLSCCL - W02 Grey RAL 9002



NEW CLASSIC SCULTURE  
NW1BLSCL - 004 Rovere Naturale

*NEW CLASSIC SCULTURE  
NW1BLSCL - 004 Rovere Naturale*



NEW CLASSIC SCULTURE  
NW1VLSCL - 004 Rovere Naturale  
V87 Vetro Grigio Trasparente Molato

NEW CLASSIC SCULTURE  
NW1VLSCL - 004 Rovere Naturale  
V87 Beveled Transparent Grey Glass





## TARSIA



DETTAGLIO  
TR1INST  
J01 Noce Tetris con  
inserto ottone  
spazzolato

*DETAIL  
TR1INST  
J01 Walnut Tetris with  
brushed brass insert*

Sono i coprifili che si nascondono dietro l'anta a rendere speciale la collezione Tarsia grazie al nuovo telaio Oltre. L'attenzione è rivolta interamente all'anta in tranciato di legno. Coprifili disponibili color parete su richiesta.

*What makes the Tarsia collection special is the casings which hide behind the shutter, thanks to the new Oltre doorframe. The attention is directed to door in wood veneer. Casings available on wall color on request.*



TARSIA

TR1INST - J01 Noce Tetris, telaio Oltre, coprifili W01 Bianco RAL 9003 con inserto ottone spazzolato

TARSIA

TR1INST - J01 Walnut Tetris, frame Oltre, W01 White RAL 9003 casings with brushed brass insert





TRISTAN  
TS2BC - J08 Rovere Tortora 4.0 con VTR vetro trasparente,  
apertura scorrevole esterno muro con binario invisibile

*TRISTAN  
TS2BC - J08 Dove Grey 4.0 Oak with VTR transparent glass,  
wall mounted sliding door with invisible tray*







DETTAGLIO TS2BC  
J08 Rovere Tortora  
e V00B vetro  
Bi-Satinato

DETAIL TS2BC  
J08 dove oak  
and V00B  
Bi-Frosted  
glass

Le bugne della collezione Tristan sembrano sospese all'interno del vetro, che regala un gioco di vedo non vedo tra gli ambienti.

*The ashlar of the Tristan collection seem to be suspended inside the glass, which enables a see-through game between the rooms.*





DETTAGLIO  
TS2V  
J08 Rovere Tortora 4.0  
vetro V83 grigio  
riflettente

*DETAIL  
TS2V  
J08 Dove Grey  
4.0 Oak  
with reflective  
grey glass V83*





DETTAGLIO  
TS2BA  
J07 Rovere Tinto  
Castagno e  
VBL vetro bianco

*DETAIL  
TS2BA  
J07 Oak Painted  
Chestnut and VBL  
white glass*





**DETTAGLIO**

TS4B - J07 Rovere Tinto Castagno Ottone anticato, V83 vetro grigio riflettente

**DETAIL**

*TS4B - J07 Oak Painted Chestnut Antique brass, V83 reflective grey glass*



TRISTAN

TS4B - J07 Rovere Tinto Castagno, V80 vetro bronzo riflettente,  
bugne rovere noce ottone anticato

TRISTAN

TS4B - J07 Oak Painted Chestnut, V80 reflective bronze glass,  
walnut oak ashlars antique brass





## ALL



DETTAGLIO  
ALLWOOD  
VTR Vetro Trasparente

*DETAIL  
ALLWOOD  
VTR Transparent Glass*

Vetro e coplanarità sono i requisiti fondamentali per la collezione All, che arreda spazi combinando un design minimale alla massima trasparenza.

*Glass and coplanarity are the fundamental requirements for the All collection which organizes spaces by combining minimal design with maximum transparency.*

ALL  
ALLWOOD VNP Vetro Nero, coprifili nero laccato

ALL  
ALLWOOD VNP Black Glass, black lacquered casings





COLLEZIONI  
*collections*

LIEVITO

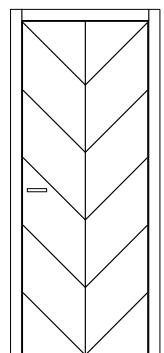

LTD

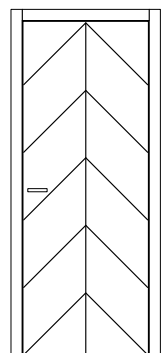

LTU

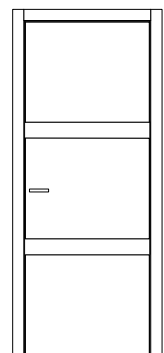

LT3B

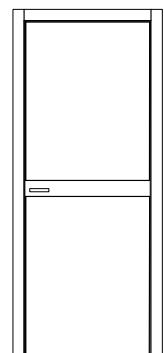

LT2B

L'OMBRA

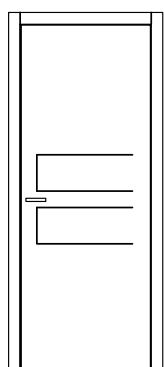

LOM2

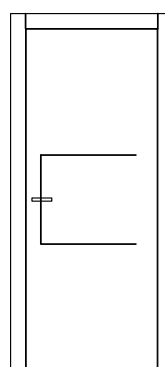

LOM1

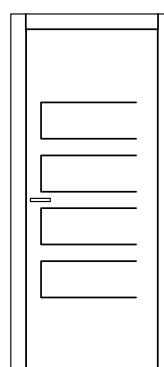

LOM4

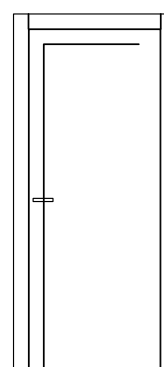

LOMA

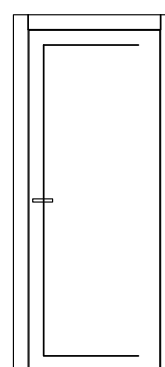

LOMC

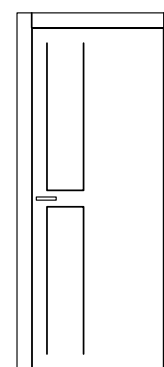

LOMC2L

EFFECT

LAYER

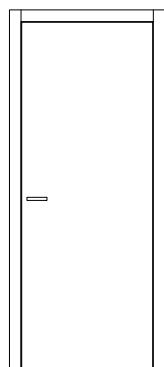

EFT1P

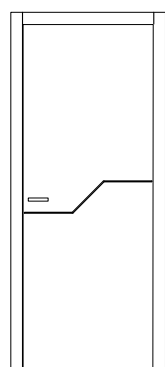

LAYINSO

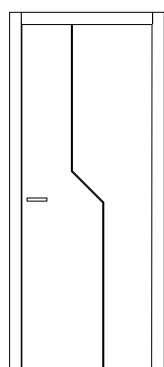

LAYINSV

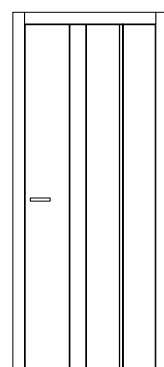

LAY3INS

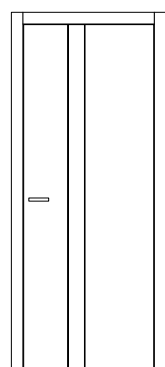

LAY2INS

DRAPPO

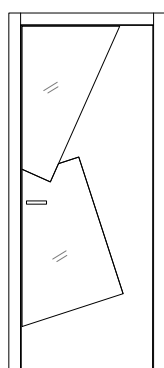

DRG

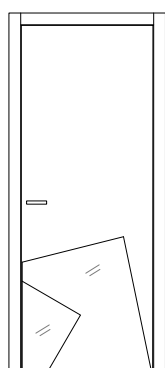

DRB

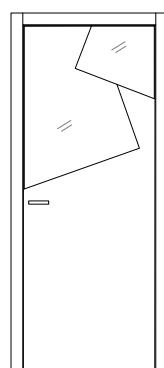

DRA

COLLEZIONI  
*collections*

SCULTURE

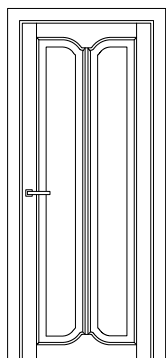

NW1BLSCL

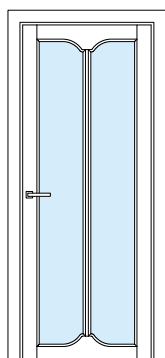

NW1VLSCL

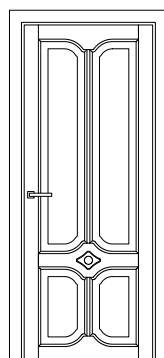

NW4BSCL

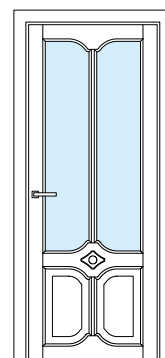

NW2B2VSCL

TARSIA

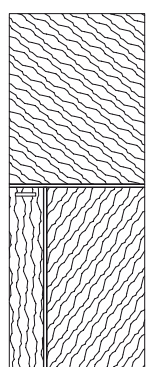

TR1INST

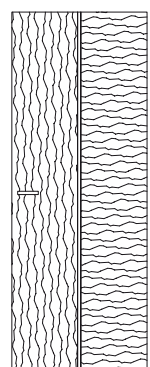

TR1INSV

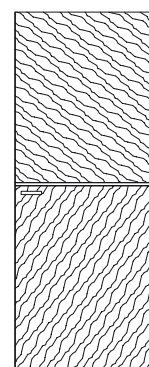

TR1INSO

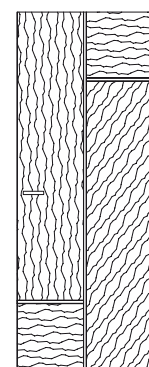

TR1INSM

TRISTAN

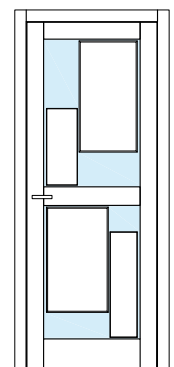

TS4B

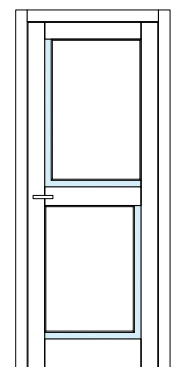

TS2BA

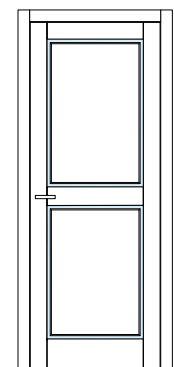

TS2BC

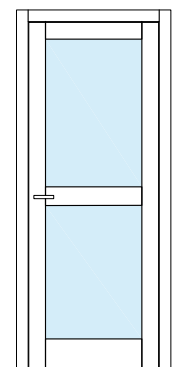

TS2V

ALL

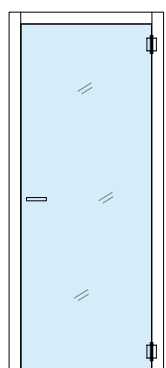

ALLWOOD

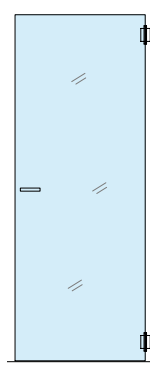

ALLRM



## FINITURE *finishes*

### COLORI LACCATI *lacquered colour*

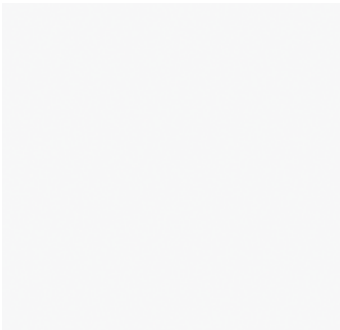

W01 BIANCO RAL 9003  
*white Ral 9003*



W02 GRIGIO RAL 9002  
*grey 9002*



W03 TORTORA  
*dove grey*

### LEGNI *wood*

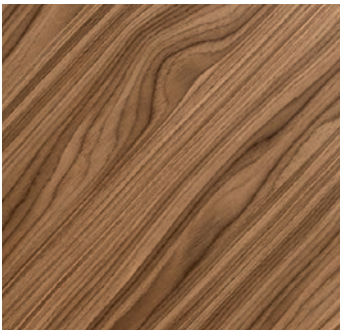

J01 NOCE TETRIS  
*walnut Tetrís*



J02 POLVERE TETRIS  
*dust Tetrís*

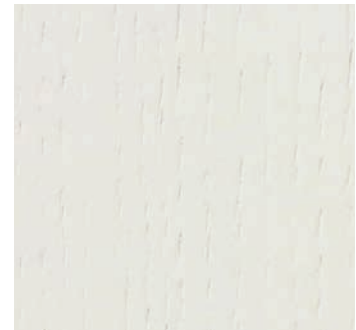

J03 ROVERE BIANCO  
*white oak*



J04 ROVERE TORTORA  
*dove grey oak*



J05 ROVERE GESSATO GRIGIO  
*pinstripe grey oak*



J06 ROVERE GRIGIO ANTRACITE  
*anthracite grey oak*

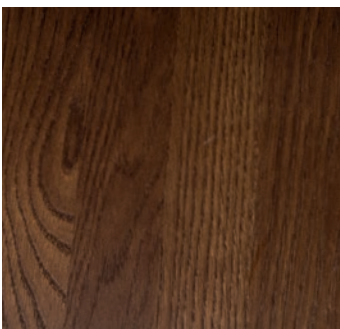

J07 ROVERE TINTO CASTAGNO  
*oak painted chestnut*



J08 ROVERE TORTORA 4.0  
*dove grey 4.0 oak*



004 ROVERE NATURALE  
*natural oak*

## VETRI *glass*



V80 BRONZO RIFLETTENTE  
*reflective bronze*



V81 BRONZO TRASPARENTE  
*transparent bronze*



V82 BRONZO BI-SATINATO  
*bi-frosted bronze*



V83 GRIGIO RIFLETTENTE  
*reflective grey*



V87 GRIGIO TRASPARENTE  
*transparent grey*



V84 GRIGIO BI-SATINATO  
*bi-frosted grey*



VNP NERO  
*black*



VBL BIANCO  
*white*

## INSERTI METALLICI *metal inserts*



CROMO SPAZZOLATO  
*brushed chrome*



ORO ROSA SPAZZOLATO  
*brushed pink gold*



OTTONE SPAZZOLATO  
*brushed brass*



## METALSHADES 4.0



X01 CALCEPURA CHIARO  
*light calceपुरa*



X02 CALCEPURA SCURO  
*dark calceपुरa*



X03 SPATOLATO GRIGIO  
*grey plaster*



Y01 ACCIAIO ANTICATO  
*antique steel*



Y02 ACCIAIO GRAFFIATO  
*scratched brass*



Y03 FERRO PELTRO  
*peltro iron*



Y04 OTTONE ANTICATO  
*antique brass*



Y05 OTTONE GRAFFIATO  
*scratched brass*



Y06 ORO ROSA GRAFFIATO  
*scratched platinum rosé*

## LACCATI 4.0

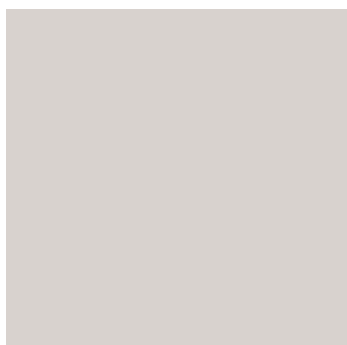

W04 ROSA SETA



W05 CIPRIA



W06 SALMONE



W07 TERRA



W08 MATTONE



W09 TORTORA BEIGE



W10 FOGLIA DA TÉ

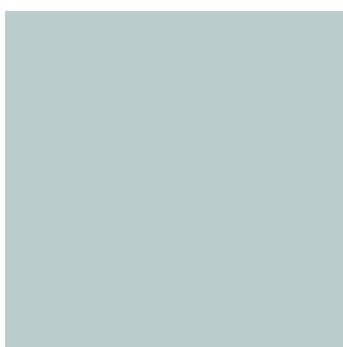

W11 GRIGIO CHIARO



W12 GRIGIO MODERNO

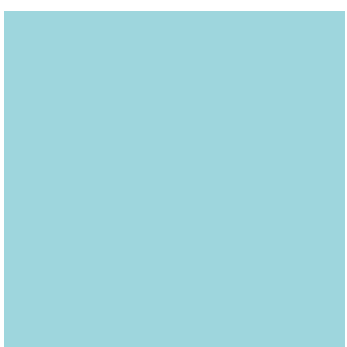

W13 CARTA ZUCCHERO



W14 MENTA CHIARA



# MANIGLIE handles

SOLID



-  Cromo Lucido Polished Chrome
-  Nikel Satinato Satin Nikel
-  Nero Opaco 9005 Matt Black 9005
-  Cromo Satinato Satin Chrome
-  Bianco RAL9016 White RAL9016

POINT



-  Cromo Lucido Polished Chrome
-  Nikel Satinato Satin Nikel
-  Cromo Satinato Satin Chrome
-  Nero Opaco 9005 Matt Black 9005





PICASSO



-  Cromo Satinato Satin Chrome
-  Nikel Satinato Satin Nikel
-  Nero Opaco 9005 Matt Black 9005

AROUND



-  Cromo Lucido Polished Chrome
-  Grafite Graphite
-  Cromo Satinato Satin Chrome
-  Nero Opaco Matt Black



SQUARE



-  Cromo Lucido Polished Chrome
-  Nikel Satinato Satin Nikel
-  Cromo Satinato Satin Chrome
-  Nero Opaco Matt Black

SCULTURE



-  Cromo Lucido Polished Chrome
-  Oro Lucido Polished Gold
-  Cromo Satinato Satin Chrome

COMBI



-  Cromo Lucido Polished Chrome
-  Nikel Perla Nikel Pearl
-  Cromo Satinato Satin Chrome

COMBI\_INS





Inserto abbinato porta  
Insert as door finish

-  Bianco Opaco Matt White
-  Nero Opaco Matt Black

WAVE



-  Cromo Lucido Polished Chrome
-  Nikel Satinato Satin Nikel
-  Cromo Satinato Satin Chrome
-  Nero Opaco Matt Black

COORDINATI  
*coordinated*



CROMO SATINATO



CROMO LUCIDO



BIANCO



NERO GRAFITE



BRONZO SCURO



OTTONE LUCIDO



CROMO SATINATO



BRONZO SCURO



BIANCO



CROMO LUCIDO



OTTONE LUCIDO



NERO



MANIGLIA INVISIBILE



TELAIO  
*doorframes*



TELAIO-COMPACT



TELAIO-FLAT



TELAIO-PLANET-W PULL  
COMPLANARE TIRARE



TELAIO-PLANET-W PUSH  
COMPLANARE SPINGERE



TELAIO-TECNO



TELAIO-EASY

TELAI  
*doorframes*

PATCH

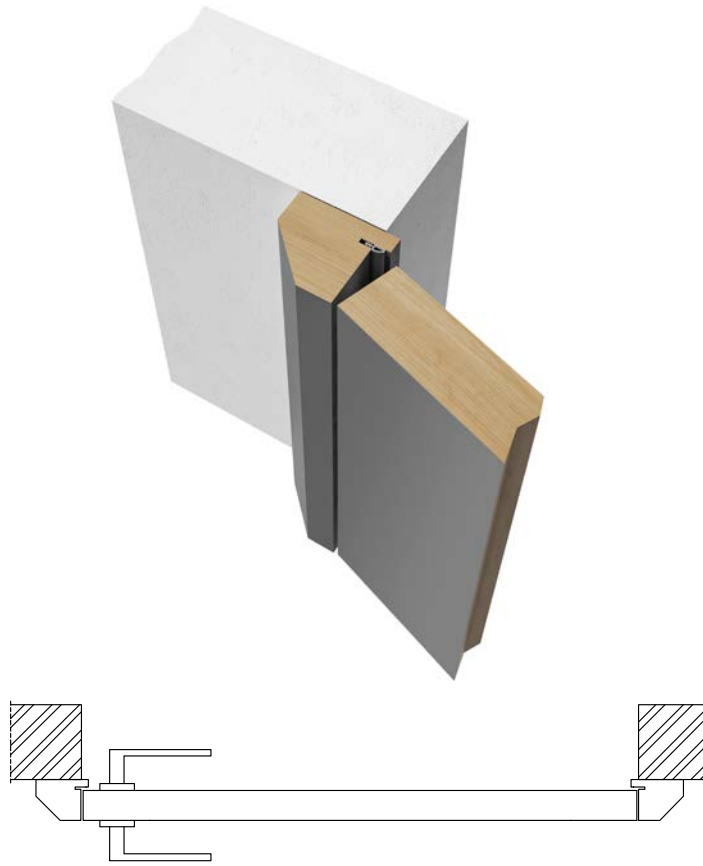

OLTRE

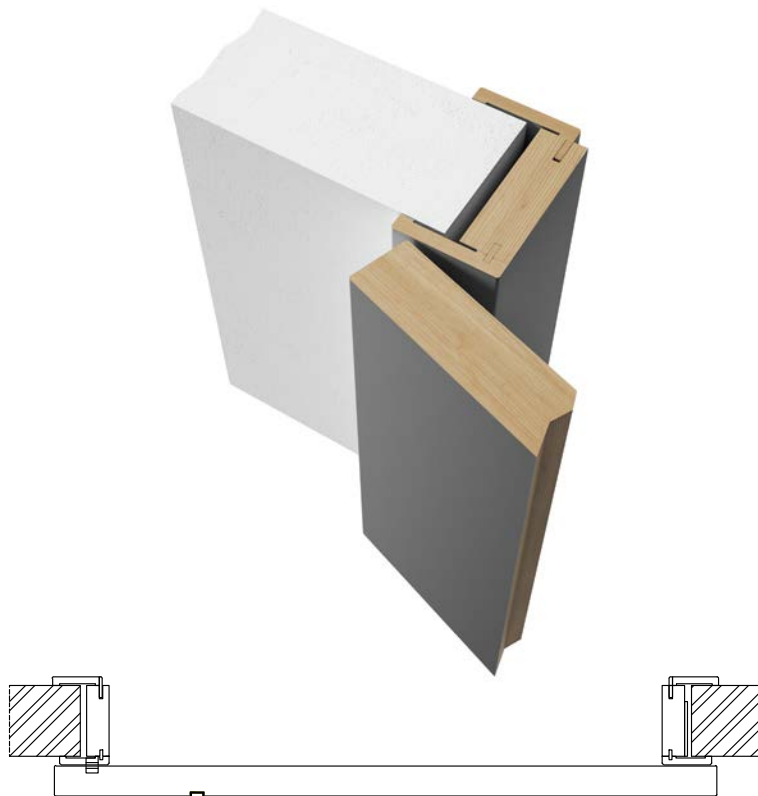









## CATALOGO 2020

---

### Modelli depositati

Tutte le immagini ed il contenuto di questo catalogo sono coperte da diritti, pertanto è vietata qualsiasi riproduzione per soggetti estranei a Romagnoli. Ogni eventuale trasgressione verrà perseguita a termini di legge.

*All right reserved*

*No pictures and parts of this catalogue may be reproduced in any form without the prior permission of Romagnoli. Trasgressione will be prosecuted to the full extend of the law.*

---

Per mantenere la tradizione nei propri prodotti, Romagnoli esegue alcune lavorazioni in modo artigianale, pertanto eventuali differenze non compromettono la qualità ma ne esaltano l'unicità.

*Romagnoli to save the tradition, using a traditional process in the production, so some imperfections mke the product unique.*

---

Il presente catalogo è un documento di proprietà della Romagnoli. I dati in esso contenuti sono da considerarsi indicativi, pertanto la proprietà si riserva la facoltà di apportare modifiche anche senza preavviso.

*All the images and the content of this catalog are covered by rights, therefore it is forbidden any reproduction for extraneous objects to Romagnoli. Every possible transgression will be pursued to terms of law.*

**Romagnoli Contract srl**  
Via Jesina, 60  
60022 - Castelfidardo (AN)  
[www.romagnolicontract.com](http://www.romagnolicontract.com)  
[info@romagnolicontract.com](mailto:info@romagnolicontract.com)